

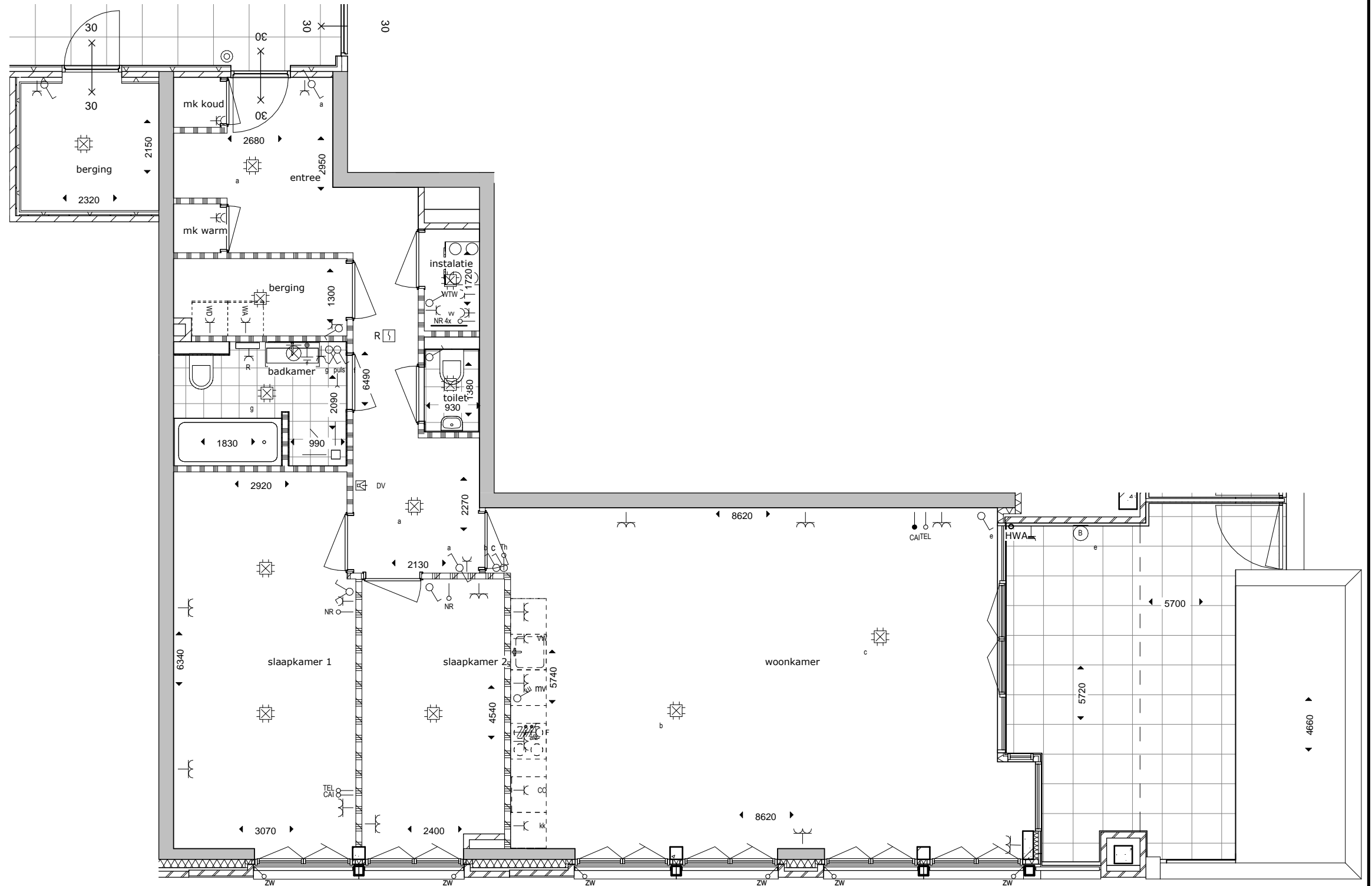

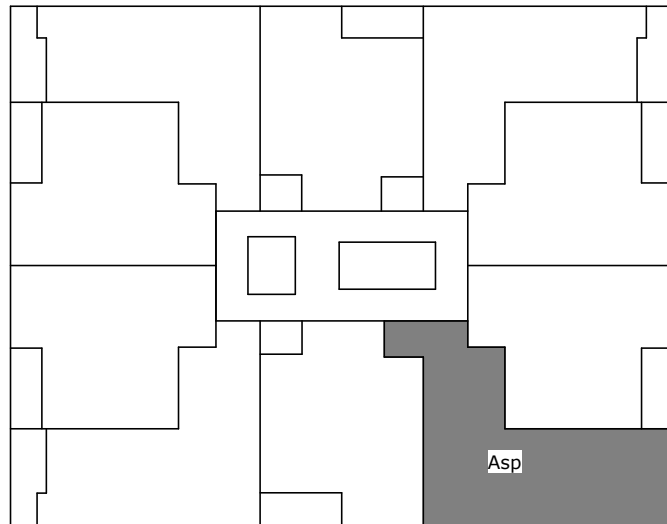







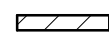

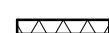

# Appartement Type A(sp)05

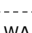
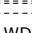

## Renvooi:

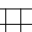
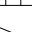
-  Betonwand
-  Kalkzandsteen
-  Ythong
-  Ythong zwaar
-  Schoon metselwerk
-  Schoon metselwerk verspringend
-  Isolatie
-  Metal stud voorzetwand
-  Douche putje 150x150
-  Electrische radiator
-  Wasautomaat
-  Wasdroger
-  Vloerverwarmings verdeler
-  Tegelvloer
-  Draai raam/deur
-  Draai-kiep raam

Bouwbedrijven Jongen BV  
 Landgraaf: Humpertweg 34, 6371 CX  
 Venlo: Noorderpoort 101, 5916 PJ  
 Postbus 31007, 6370 AA LANDGRAAF  
 Telefoon: +31 (0)88 186 12 00  
 www.bouwbedrijvenjongen.nl

**DEFINITIEF  
 VOOR VERKOOP**

Accoord  
 D.D. 12-10-2018



**Koningswinkelstraat 3**  
**6301 WH Valkenburg**  
**T +31(0)43 - 601 36 37**  
**F +31(0)43 - 601 54 85**  
**@ info@paltebv.nl**  
**I www.paltebv.nl**

**Werk:**  
**Sphinx Zuid Maastricht**

**Onderdeel:**  
**Appartement A(sp) begane grond (05)**

**Get. :** T.Moulen  
**Gec. :** D.Loo  
**Goedg.:**

**Projectno.:**  
**470266**

**Blad:**  
**B7\_VK012**

**Wijziging:**  
**C**  
 12-10-2018

**Datum :** 31-08-2018  
**Schaal :** 1 : 75

**Formaat:** A3